

Valve Automation Technology When and Where You Need It



TEC2 Electric Actuator With Model 500

Intelligent Electric Valve Actuation Made Simple (Model 500 Discontinued)



High Performance Digital Valve Control Made Easy



TEC2

Proven technology in electric actuation coupled with simplified digital controls, TEC2 is the next step in reliable high-performance digital valve control to make your work easier and safer.

Enhanced data-logging feature with time and date stamp features provide you with information to make effective and timely preventive maintenance decisions.

TEC2 Key Benefits:

- Advanced configuration, diagnostics and predictive capability through DCMLink™ remote diagnostic, configuring and monitoring software with integration path to AMS Device Manager, Delta V, Emerson PlantWeb
- Ease of Use and Service - Multiple languages, improved graphical display, patented remote module
- Non-Intrusive design & rugged ductile iron gear housing is shock and vibration-resistant
- Non-penetrating, vibration-resistant Hall Effect switches enable setup without opening control compartments
- Discrete, analog and digital controls availability
- Open network control for a wide range of topologies and protocols, including Modbus RTU, Profibus, FOUNDATION™ Fieldbus, DeviceNet™, Ethernet, HART™ and Wireless HART™

TEC2* Certifications:

- F.M., C.S.A., CE, IECEx, GOST, InMetro, CEPEL, AWWA C542, ATEX
- Shock & Vibration (MIL-STD-167-1, MIL-STD-901D)
- IP68 certified for submersible applications (50 ft, 7 days)
- SIL

CE **IP68**

More Flexibility and Reliability Through Innovative Product Design

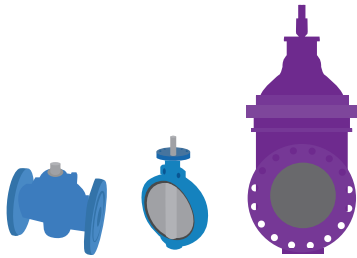

Robust and compact design that are widely used on valves for marine, oil and gas, chemical, power, and water and wastewater applications.

Hall-Effect Torque Sensing Technology

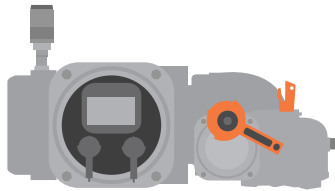

Accurate torque sensing using rotary Hall-Effect encoder directly connected to torque pinion is active in both motor and manual operation.



Compact profile patented Remote Display Module puts local controls within easy access for safe operation, diagnostics, configuration or monitoring for hard to reach locations or limited access areas.

Simplified Intelligence, When You Need It, Where You Need It

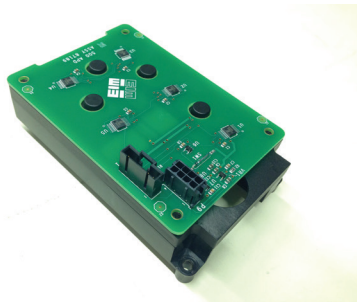

Absolute Position Detector provides precise valve position under all conditions including loss of power, no battery backup required.

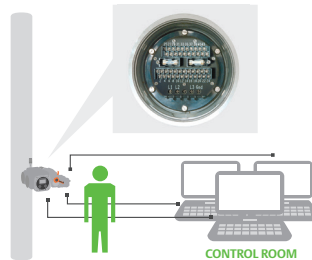

Separate Terminal Chamber dual sealed separate terminal chamber with highly legible terminal markings and pre-installed screws eases field wiring. Primary fuses accessible without opening controls compartments.

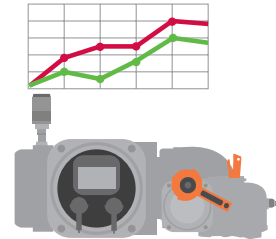

Process Trends Measured & Recorded historical logs can reveal process trends to help with maintenance intervals and improve the timeliness of predictive maintenance enhanced with the use of DCMLink™ remote diagnostics, configuring, and monitoring software.

Maximize Plant Efficiency and Safety Every Time

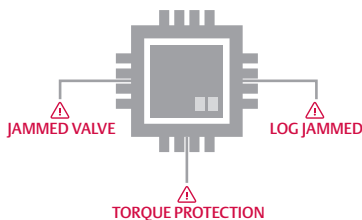

Programmable Monitoring performance data can be monitored to fix current problems and recorded to analyze future issues.

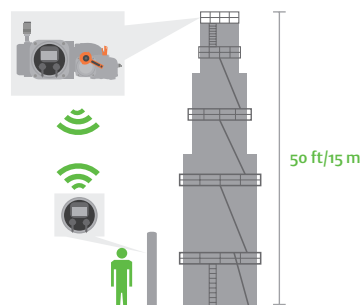

Safe, Convenient Calibration & Operation patented Remote Display Module (RDM) allows control and monitoring up to 4,000 ft (1.2 km) away which is ideal for hazardous environments.



Reliable Process Insight For Every Application

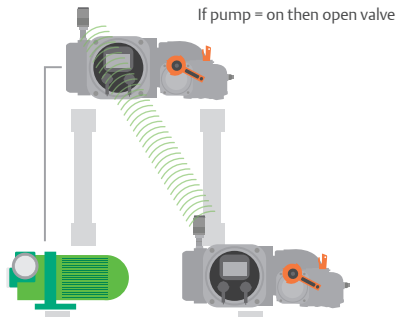

Prevent untimely operation with a built-in inhibitor interlock system that prevents operation with other devices until external contact has been made. Your systems can now coordinate with each other.

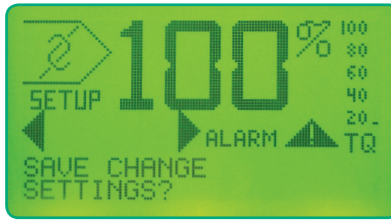

Your displays need to show the right information without being too simple or complex. Easy to read IconoText displays and icons allow for an easy and intuitive setup.

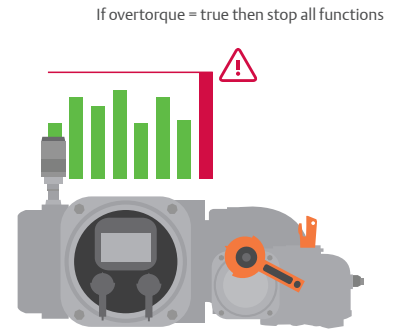

Configurable process alarms are standard - TEC2 will alert you of any issues in your process and alarms can also be set to trigger open or close functions.

World Area Configuration Centers (WACC) offer sales support, service, inventory and commissioning to our global customers. Choose the WACC or sales office nearest you:

NORTH & SOUTH AMERICA

19200 Northwest Freeway
Houston TX 77065
USA
T +1 281 477 4100

Av. Hollingsworth
325 Iporanga Sorocaba
SP 18087-105
Brazil
T +55 15 3413 8888

ASIA PACIFIC

No. 9 Gul Road
#01-02 Singapore 629361
T +65 6777 8211

No. 1 Lai Yuan Road
Wuqing Development Area
Tianjin 301700
P. R. China
T +86 22 8212 3300

MIDDLE EAST & AFRICA

P. O. Box 17033
Jebel Ali Free Zone
Dubai
T +971 4 811 8100

P. O. Box 10305
Jubail 31961
Saudi Arabia
T +966 3 340 8650

24 Angus Crescent
Longmeadow Business Estate East
P.O. Box 6908 Greenstone
1616 Modderfontein Extension 5
South Africa
T +27 11 451 3700

EUROPE

Holland Fasor 6
Székesfehérvár 8000
Hungary
T +36 22 53 09 50

Strada Biffi 165
29017 Fiorenzuola d'Arda (PC)
Italy
T +39 0523 944 411



Scan QR code for complete technical and installation documentation.



For complete list of sales and manufacturing sites, please visit www.emerson.com/actuationtechnologieslocations or contact us at info.actuationtechnologies@emerson.com

©2018 Emerson. All rights reserved.

The Emerson logo is a trademark and service mark of Emerson Electric Co. EIM™ is a mark of the Emerson family of companies. All other marks are property of their respective owners.